



NOTE:

THE FOLLOWING CLEARANCES MUST BE MAINTAINED AT ALL TIMES;

- a) A 50-FOOT RADIUS AROUND SUSPENSION TOWER LEGS, H-FRAMES & 100-FOOT RADIUS AROUND DEAD-END TOWER LEGS.
- b) A 25-FOOT RADIUS AROUND ALL OTHER POLES.

LEGEND

-  PROPERTY OF SOUTHERN CALIFORNIA EDISON COMPANY
-  PROPERTY BEING LICENSED TO CITY OF FONTANA FOR ACCESS/ROADS

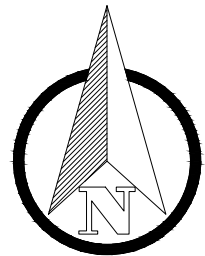
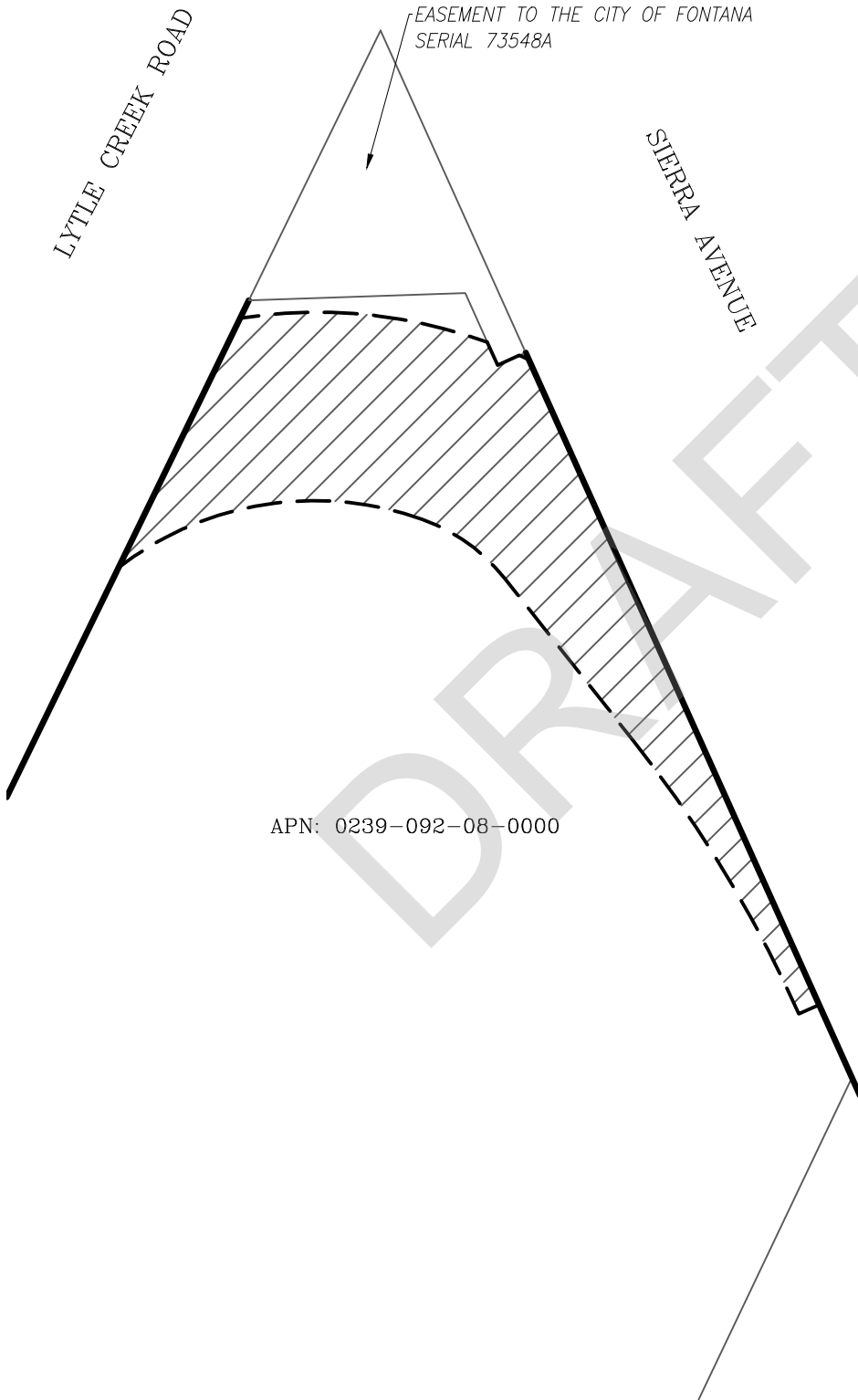

EXHIBIT "A"

FACILITY NAME: LUGO – MIRA LOMA 500 KV T/L R/W			LICENSED AREA (GROSS)		SQ.FT.: 5,433	AC.: 0.125
LICENSEE: CITY OF FONTANA				CONTRACT NO.: 9.8611		ACCOUNT NO.: N/A
CITY: FONTANA		COUNTY: SAN BERNARDINO		STATE: CA	T.G.: 544/H5	M.S.: 057-100
APN.(S): 0239-093-08-0000; 0239-092-08-00000				SCE DOCUMENT NO.: 306332/001		
SCE SANDERS MAP: 2102288		SCE LAND BOOK: N/A		REF: N/A		
R.P. LAND AGENT: M. CONTRERAS		SURVEY MAPPING: R. HERNANDEZ		CHECKED BY: R. WADDELL		
ORDER NO.: 801168874	NOT. NO.: 202718642	DATE: 06/03/2024	FILE NAME: 9.8611.DWG			

