

PROPOSED BOUNDARIES OF CITY OF FONTANA COMMUNITY FACILITIES DISTRICT NO. 81 (GABRIELLA)

COUNTY OF SAN BERNARDINO, STATE OF CALIFORNIA.

BASIS OF BEARINGS:

THE BEARINGS SHOWN HEREON ARE BASED ON THE CENTERLINE OF SIERRA AVENUE, PER TRACT 17634, M.B. 340/72-73, BEING: N 00°00'12"

PROPOSED BOUNDARIES:

THE PROPOSED BOUNDARIES OF CITY OF FONTANA COMMUNITY FACILITIES DISTRICT NO. 81 (GABRIELLA) CONTAINS 35.70 ACRES OF LAND MORE OR LESS.

REFERENCE IS HEREBY MADE TO THE ASSESSOR MAPS OF THE COUNTY OF SAN BERNARDINO FOR A DESCRIPTION OF THE LINES AND DIMENSIONS OF THE PARCELS LISTED BELOW.

0241-091-17	0241-091-38
0241-091-19	0241-091-39
0241-091-22	0241-091-42
0241-091-24	0241-091-43
0241-091-25	0241-091-52
0241-091-29	0241-091-53
0241-091-31	0241-091-64

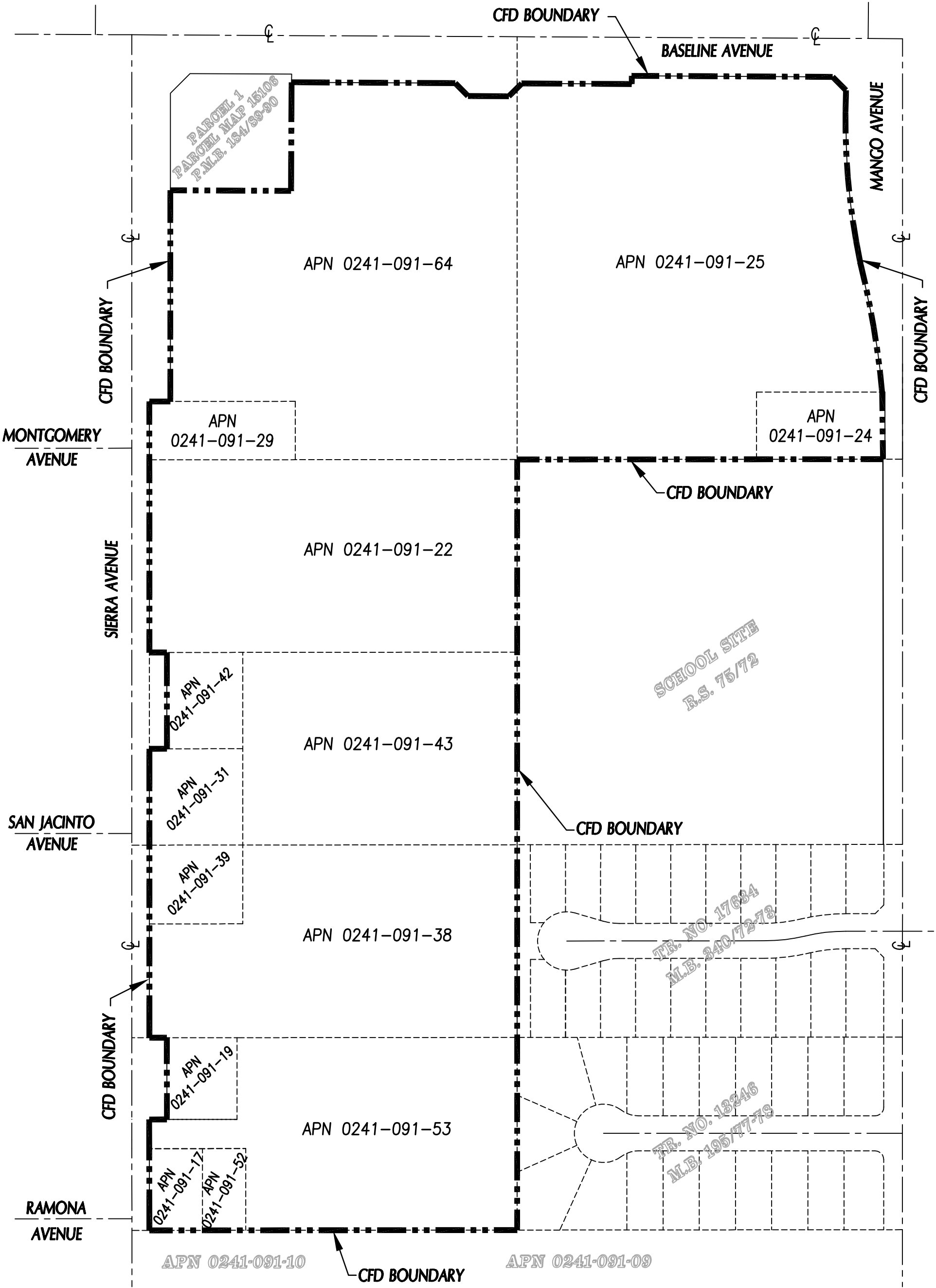

CITY CLERK'S CERTIFICATE:

FILED IN THE OFFICE OF THE CITY CLERK OF THE CITY OF FONTANA THIS \_\_\_\_\_ DAY OF \_\_\_\_\_, 2016

CITY CLERK OF THE CITY OF FONTANA

I HEREBY CERTIFY THAT THE WITHIN MAP SHOWING THE PROPOSED BOUNDARIES OF CITY OF FONTANA COMMUNITY FACILITIES DISTRICT NO. 81 (GABRIELLA), COUNTY OF BERNARDINO, STATE OF CALIFORNIA, WAS APPROVED BY THE CITY COUNCIL OF THE CITY OF FONTANA AT A REGULAR MEETING THEREOF, HELD ON THE \_\_\_\_\_ DAY OF \_\_\_\_\_, 2016, BY ITS RESOLUTION NO. \_\_\_\_\_

CITY CLERK OF THE CITY OF FONTANA

SAN BERNARDINO COUNTY RECORDER'S CERTIFICATE:

FILED THIS \_\_\_\_\_ DAY OF \_\_\_\_\_, 2016, AT THE HOUR OF \_\_\_\_\_ O'CLOCK \_\_\_\_\_ M. IN BOOK \_\_\_\_\_ OF MAPS OF ASSESSMENT AND COMMUNITY FACILITIES DISTRICTS AT PAGE \_\_\_\_\_, AND UNDER DOCUMENT NUMBER \_\_\_\_\_, IN THE OFFICE OF THE COUNTY RECORDER IN THE COUNTY OF SAN BERNARDINO, STATE OF CALIFORNIA, AT THE REQUEST OF THE CITY OF FONTANA, IN THE AMOUNT OF \$ \_\_\_\_\_

BOB DUTON, ASSESSOR - RECORDER - COUNTY CLERK  
COUNTY OF SAN BERNARDINO

BY: \_\_\_\_\_  
DEPUTY RECORDER

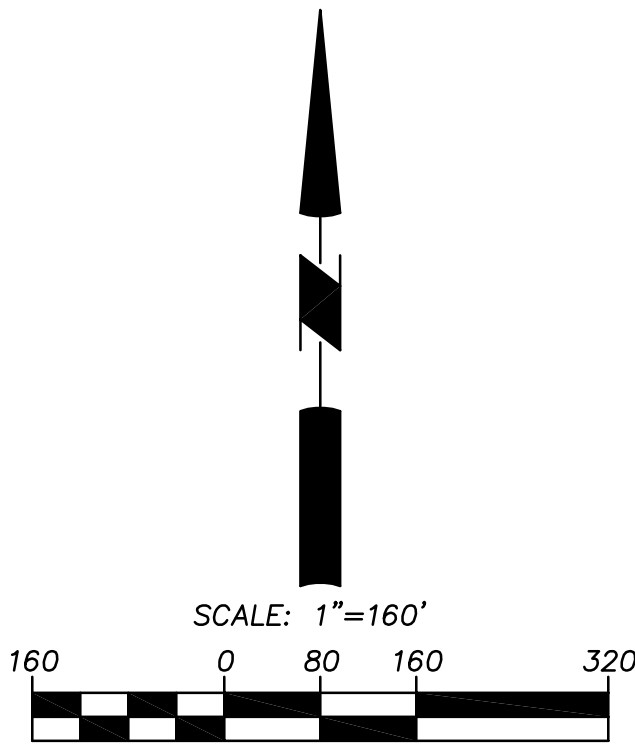

PROPOSED BOUNDARIES OF CITY OF FONTANA COMMUNITY FACILITIES DISTRICT NO. 81 (GABRIELLA)

COUNTY OF SAN BERNARDINO, STATE OF CALIFORNIA.

ALLARD ENGINEERING  
16866 SEVILLE AVENUE  
FONTANA, CA 92335  
(909) 356-1815 FAX: (909) 356-1795

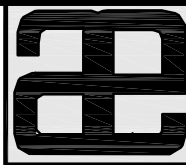

SHEET  
1 OF 1